

ELEKTRA

DUNDAS 375

STUDIO, 1 BATH
 INTERIOR: 375 SQ.FT
 BALCONY: 60 SQ.FT
 TOTAL: 435 SQ.FT

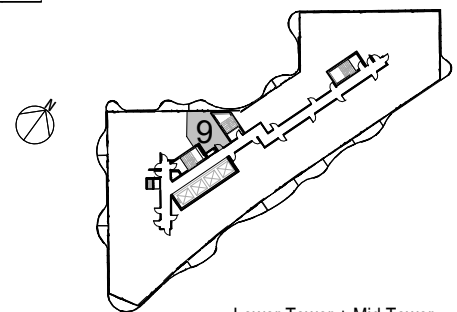
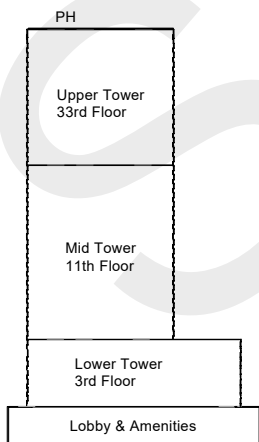
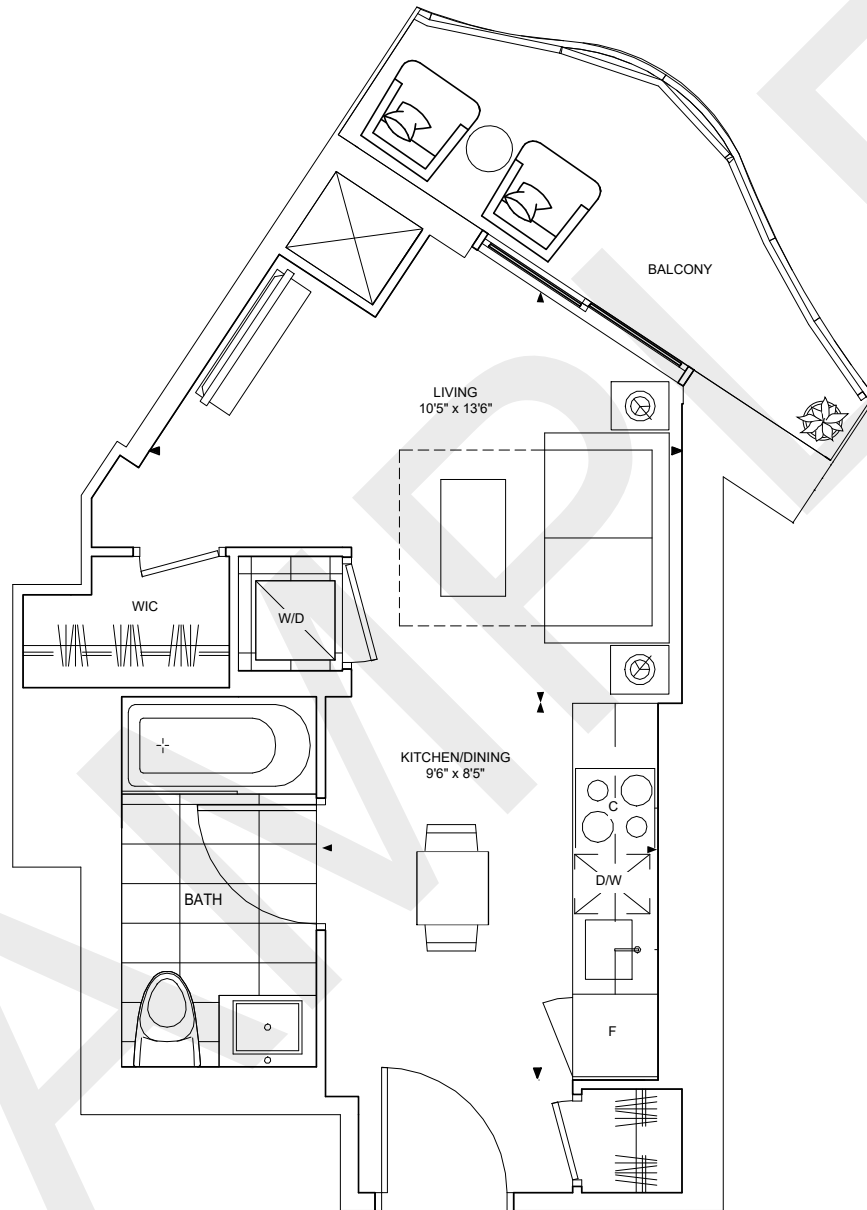

*Prices, sizes and specifications subject to change without notice, E.&O.E. The dimensions shown of this plan are approximate and subject to normal construction variances. Actual useable floor space within the unit may vary from any stated floor areas or dimensions on this plan. Furniture is displayed for illustration purposes only and does not necessarily reflect the electrical plan for the suite. Suites are sold unfurnished. For more information on the method used for calculating the floor area of any unit, reference should be made to Home Construction Regulatory Authority ("HCRA") Directive.

ELEKTRA

TIMES 436

1 BED, 1 BATH
 INTERIOR 436 SQ.FT
 BALCONY 33 SQ.FT
TOTAL 469 SQ.FT

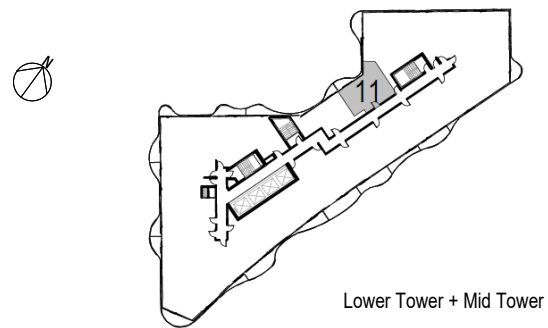
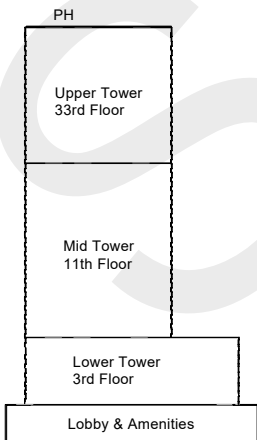
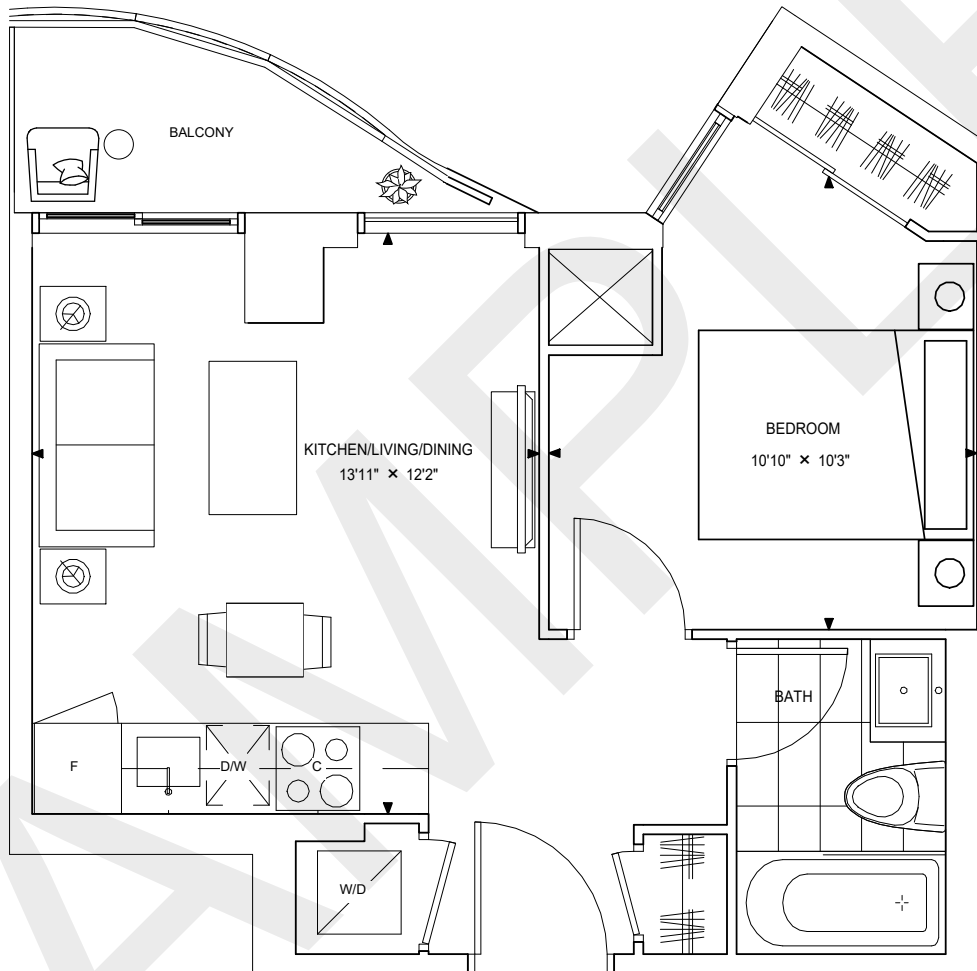

*Prices, sizes and specifications subject to change without notice. E.&O.E. The dimensions shown of this plan are approximate and subject to normal construction variances. Actual useable floor space within the unit may vary from any stated floor areas or dimensions on this plan. Furniture is displayed for illustration purposes only and does not necessarily reflect the electrical plan for the suite. Suites are sold unfurnished. For more information on the method used for calculating the floor area of any unit, reference should be made to Home Construction Regulatory Authority ("HCRA") Directive.

ELEKTRA

TIMES 486

1 BED, 1 BATH
 INTERIOR: 486 SQ.FT
 BALCONY: 43 SQ.FT
TOTAL: 529 SQ.FT

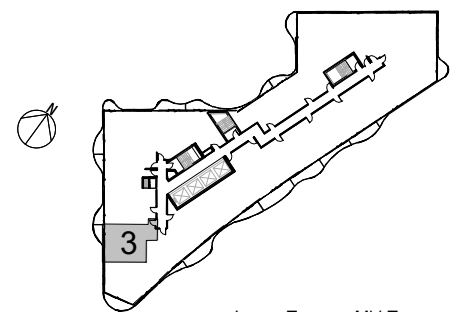
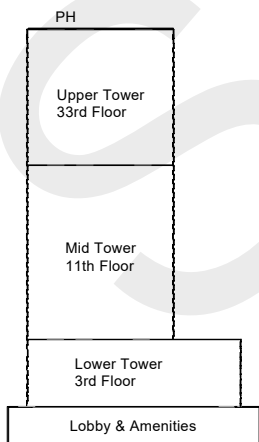
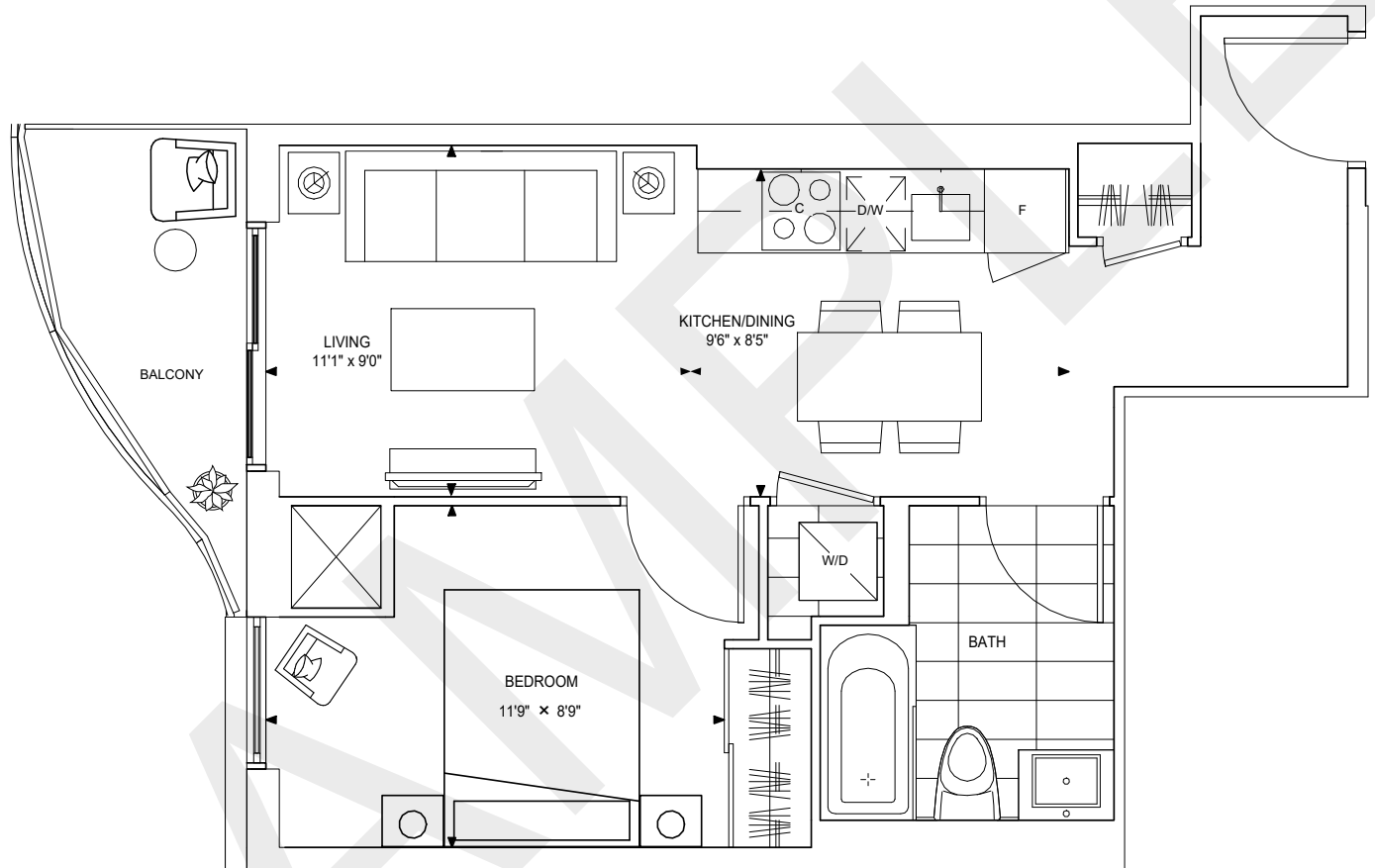

Lower Tower + Mid Tower



*Prices, sizes and specifications subject to change without notice, E.&O.E. The dimensions shown of this plan are approximate and subject to normal construction variances. Actual useable floor space within the unit may vary from any stated floor areas or dimensions on this plan. Furniture is displayed for illustration purposes only and does not necessarily reflect the electrical plan for the suite. Suites are sold unfurnished. For more information on the method used for calculating the floor area of any unit, reference should be made to Home Construction Regulatory Authority ("HCRA") Directive.

ELEKTRA

TIMES 446

1 BED, 1 BATH
INTERIOR: 446 SQ.FT
BALCONY: 52 SQ.FT
TOTAL: 498 SQ.FT

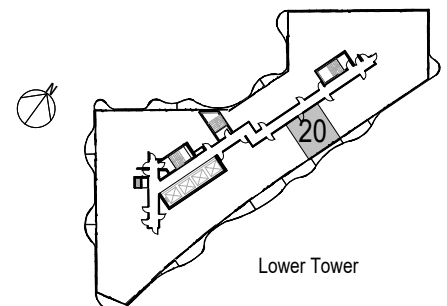
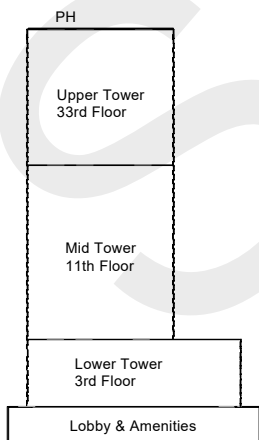
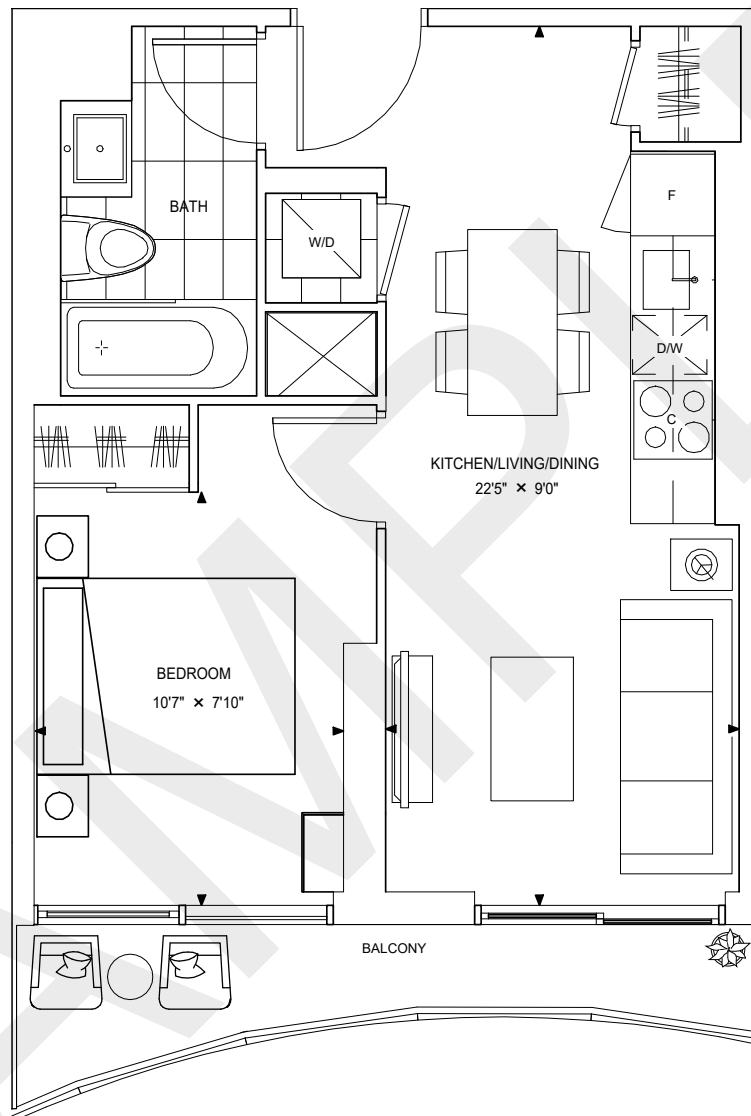

*Prices, sizes and specifications subject to change without notice, E.&O.E. The dimensions shown of this plan are approximate and subject to normal construction variances. Actual useable floor space within the unit may vary from any stated floor areas or dimensions on this plan. Furniture is displayed for illustration purposes only and does not necessarily reflect the electrical plan for the suite. Suites are sold unfurnished. For more information on the method used for calculating the floor area of any unit, reference should be made to Home Construction Regulatory Authority ("HCRA") Directive.

ELEKTRA

PIAZZA 534

1 BED + DEN, 1 BATH
INTERIOR: 534 SQ.FT
BALCONY: 67 SQ.FT
TOTAL: 601 SQ.FT

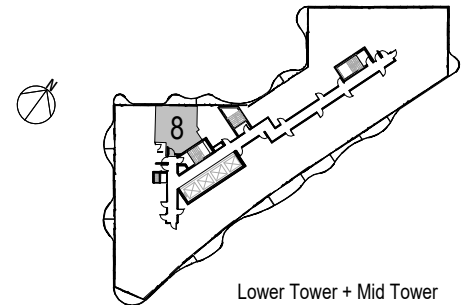
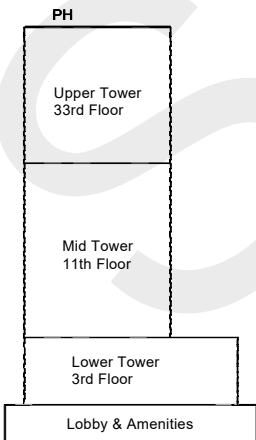
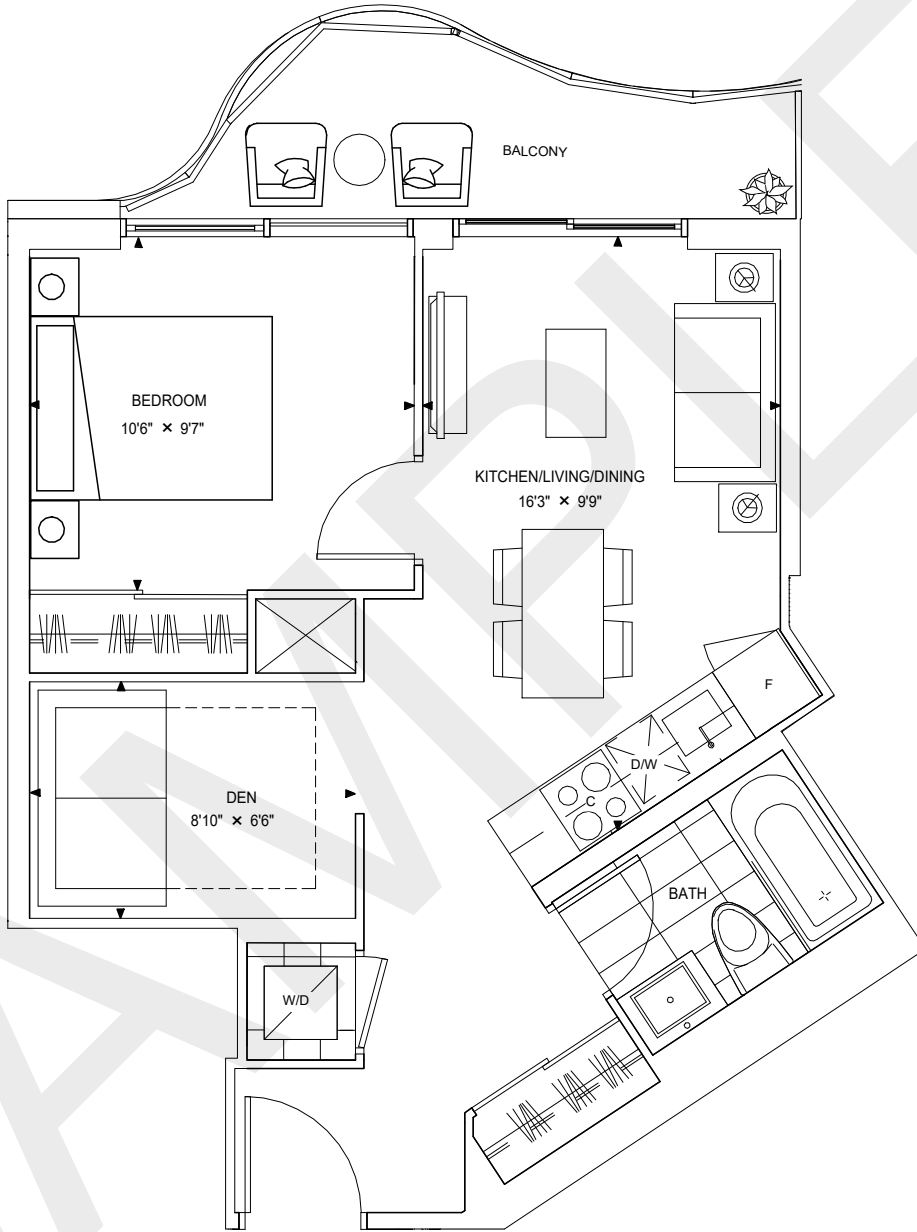

*Prices, sizes and specifications subject to change without notice, E.&O.E. The dimensions shown of this plan are approximate and subject to normal construction variances. Actual useable floor space within the unit may vary from any stated floor areas or dimensions on this plan. Furniture is displayed for illustration purposes only and does not necessarily reflect the electrical plan for the suite. Suites are sold unfurnished. For more information on the method used for calculating the floor area of any unit, reference should be made to Home Construction Regulatory Authority ("HCRA") Directive.

ELEKTRA

PIAZZA 593

1 BED + DEN, 1 BATH
 INTERIOR: 593 SQ.FT
 BALCONY: 64 SQ.FT
 TOTAL: 657 SQ.FT

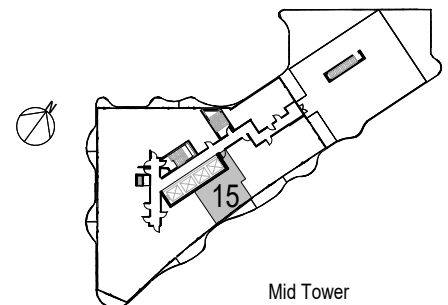
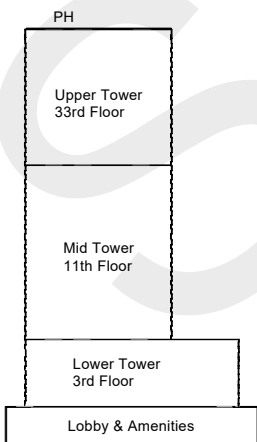
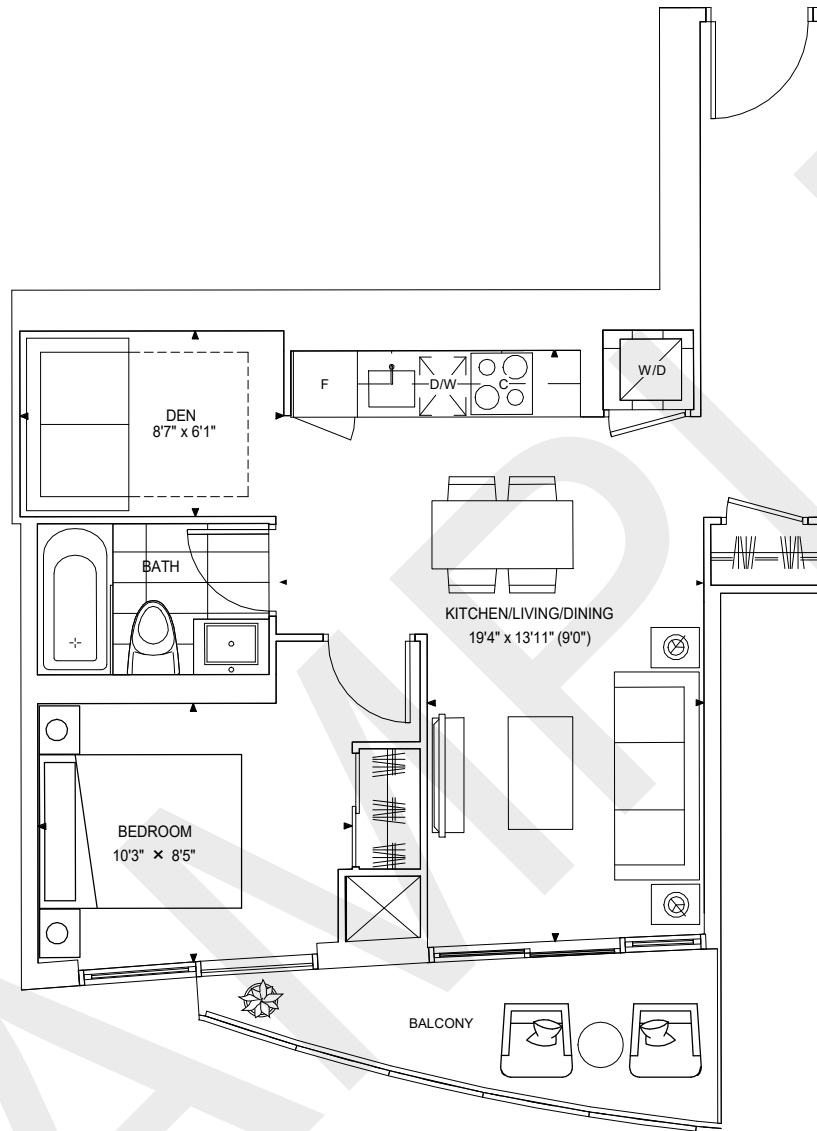

*Prices, sizes and specifications subject to change without notice, E.&O.E. The dimensions shown of this plan are approximate and subject to normal construction variances. Actual useable floor space within the unit may vary from any stated floor areas or dimensions on this plan. Furniture is displayed for illustration purposes only and does not necessarily reflect the electrical plan for the suite. Suites are sold unfurnished. For more information on the method used for calculating the floor area of any unit, reference should be made to Home Construction Regulatory Authority ("HCRA") Directive.

ELEKTRA

PICCADILLY 629

1 BED + DEN, 2 BATH
 INTERIOR: 629 SQ.FT
 BALCONY 1 & 2: 98 SQ.FT
TOTAL: 727 SQ.FT

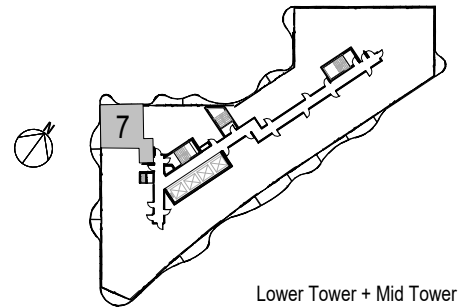
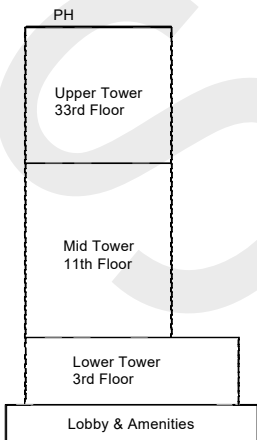
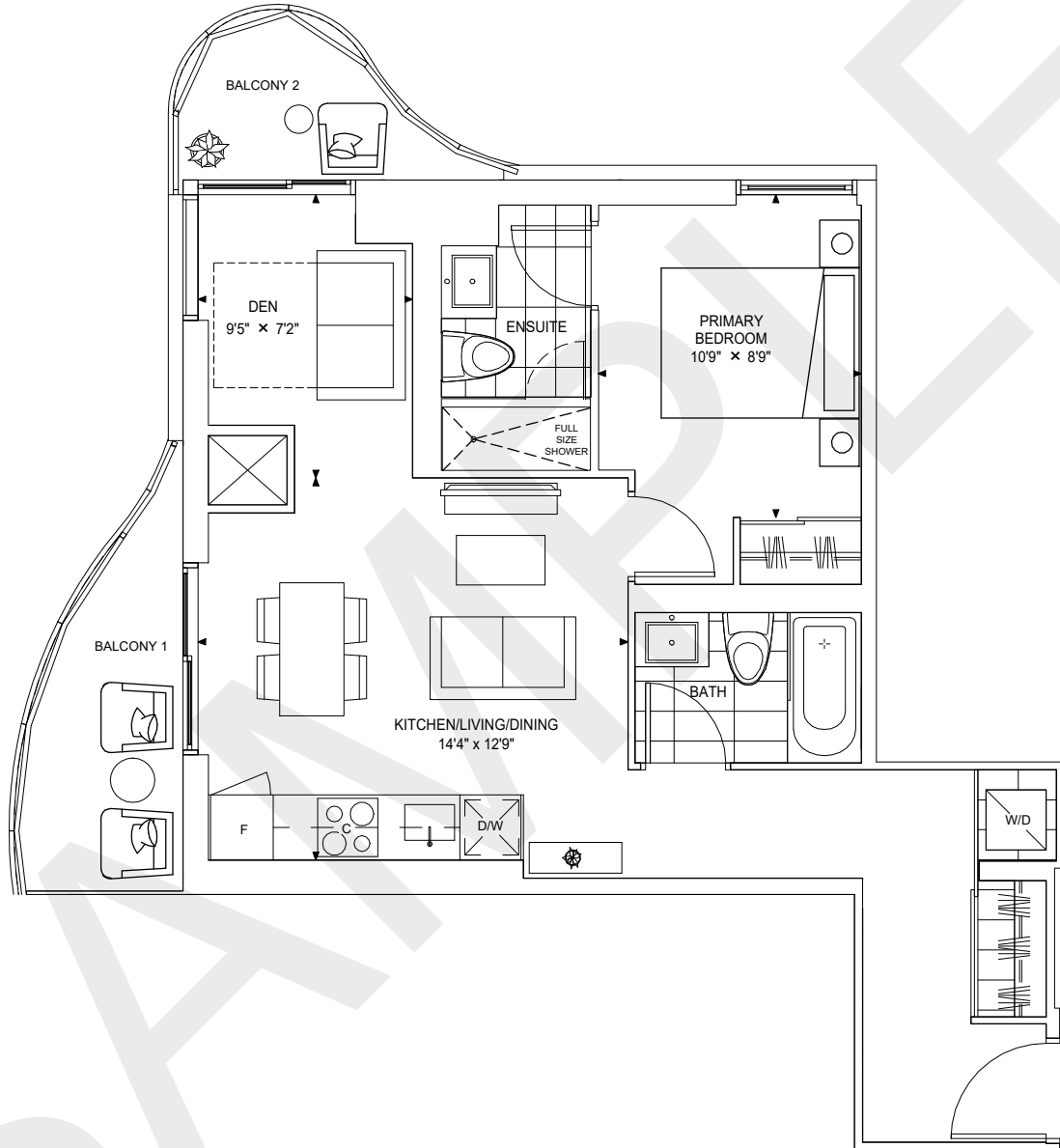

Lower Tower + Mid Tower



*Prices, sizes and specifications subject to change without notice. E.&O.E. The dimensions shown of this plan are approximate and subject to normal construction variances. Actual useable floor space within the unit may vary from any stated floor areas or dimensions on this plan. Furniture is displayed for illustration purposes only and does not necessarily reflect the electrical plan for the suite. Suites are sold unfurnished. For more information on the method used for calculating the floor area of any unit, reference should be made to Home Construction Regulatory Authority ("HCRA") Directive.

ELEKTRA

SHIBUYA 684

2 BED, 2 BATH
INTERIOR: 684 SQ.FT
TOTAL: 684 SQ.FT

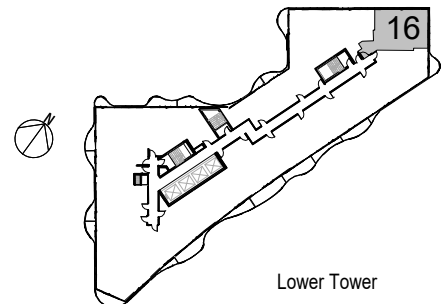
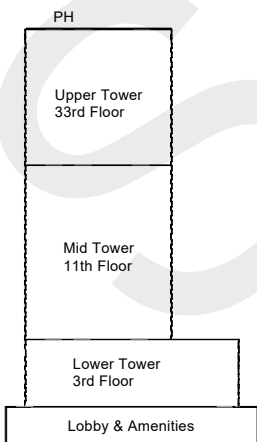
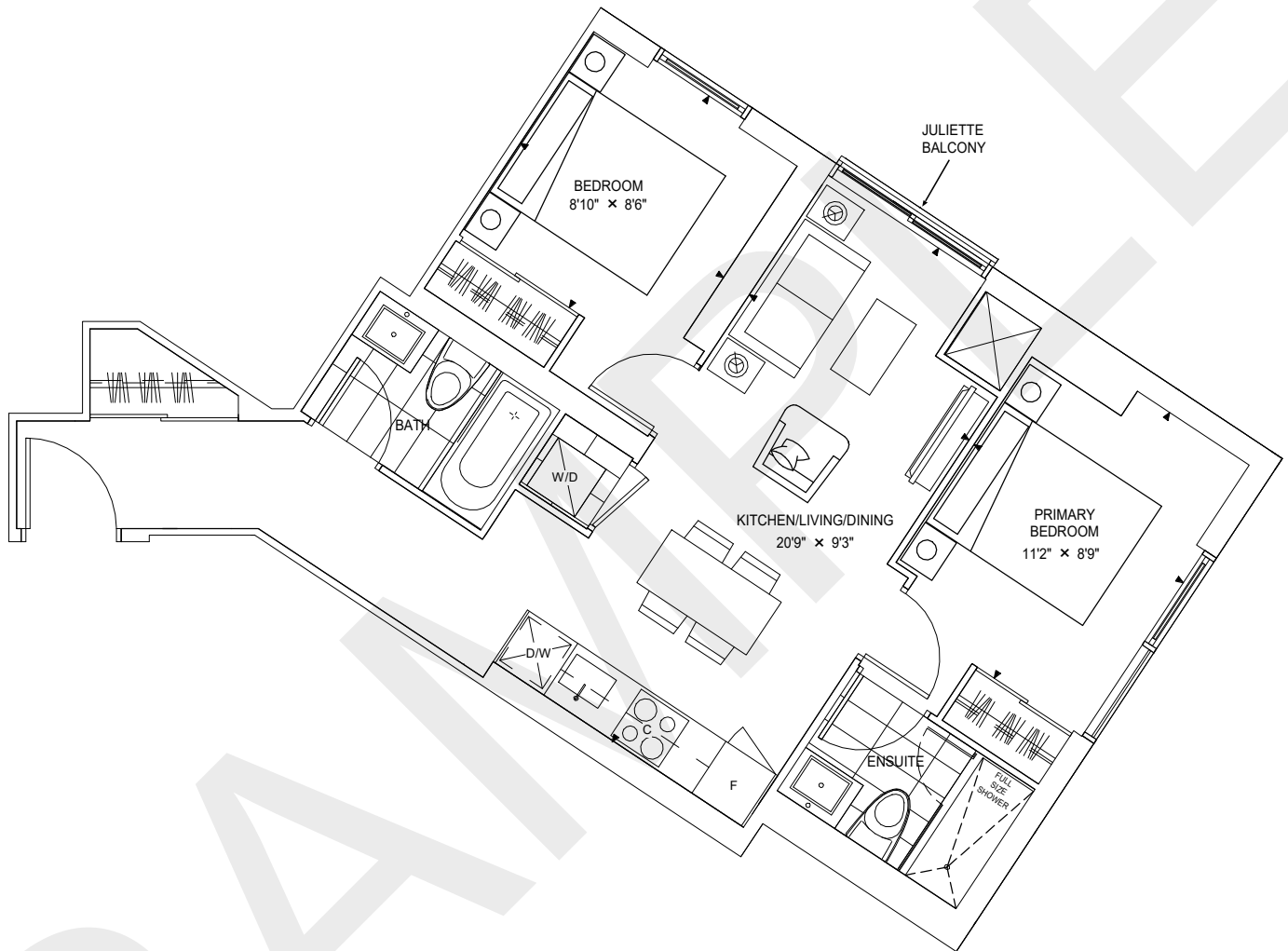

*Prices, sizes and specifications subject to change without notice, E.&O.E. The dimensions shown of this plan are approximate and subject to normal construction variances. Actual useable floor space within the unit may vary from any stated floor areas or dimensions on this plan. Furniture is displayed for illustration purposes only and does not necessarily reflect the electrical plan for the suite. Suites are sold unfurnished. For more information on the method used for calculating the floor area of any unit, reference should be made to Home Construction Regulatory Authority ("HCRA") Directive.

ELEKTRA

SHIBUYA 670

2 BED, 2 BATH
 INTERIOR: 670 SQ.FT
 BALCONY: 105 SQ.FT
 TOTAL: 775 SQ.FT

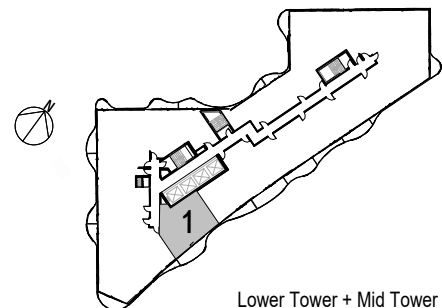
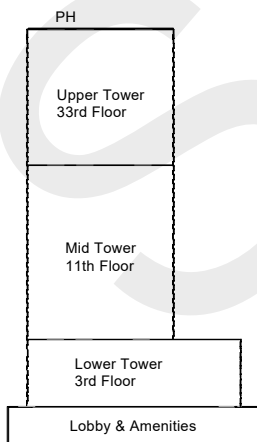
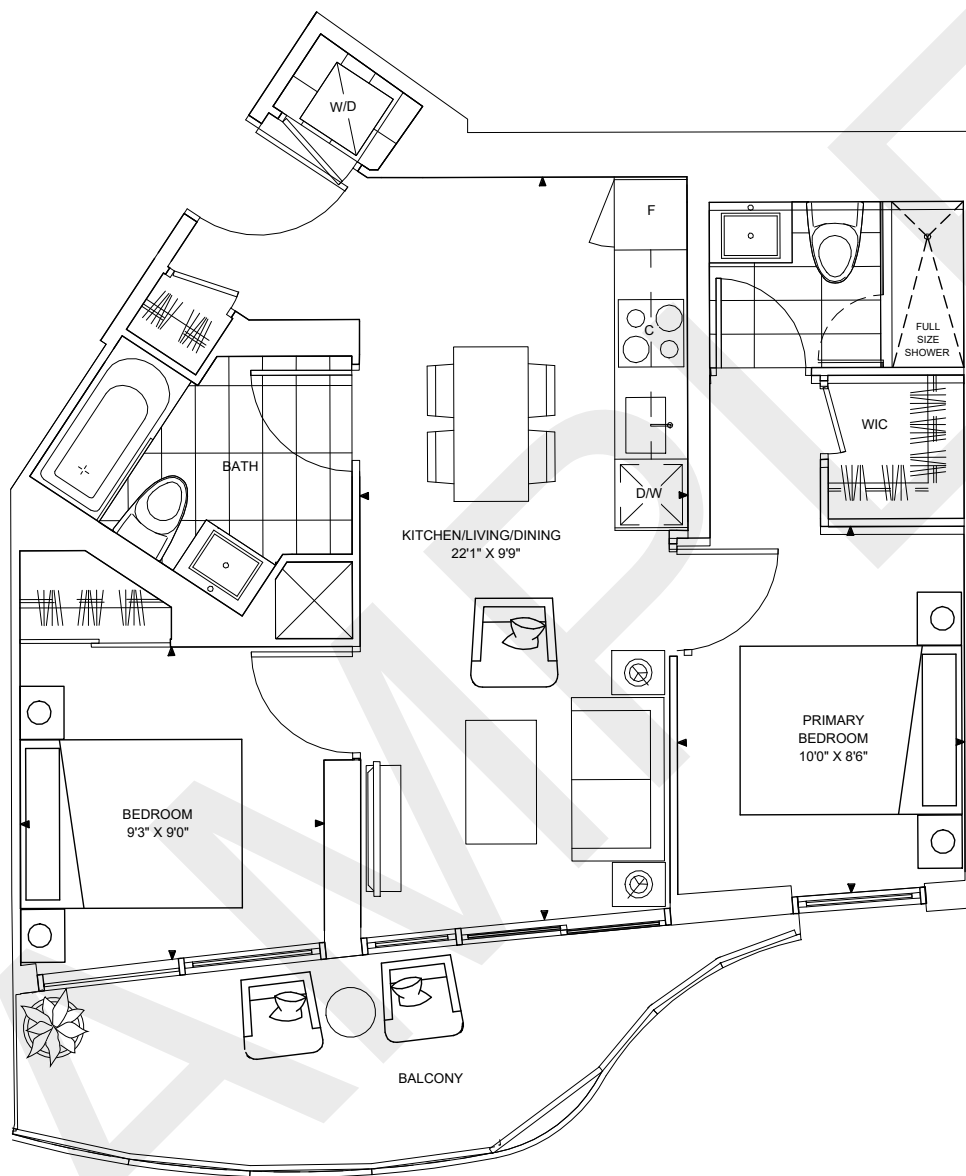

Lower Tower + Mid Tower



*Prices, sizes and specifications subject to change without notice, E.&O.E. The dimensions shown of this plan are approximate and subject to normal construction variances. Actual useable floor space within the unit may vary from any stated floor areas or dimensions on this plan. Furniture is displayed for illustration purposes only and does not necessarily reflect the electrical plan for the suite. Suites are sold unfurnished. For more information on the method used for calculating the floor area of any unit, reference should be made to Home Construction Regulatory Authority ("HCRA") Directive.

ELEKTRA

GRAND 909

3 BED, 2 BATH
 INTERIOR: 909 SQ.FT
 BALCONY 1 & 2: 100 SQ.FT
 TOTAL: 1009 SQ.FT

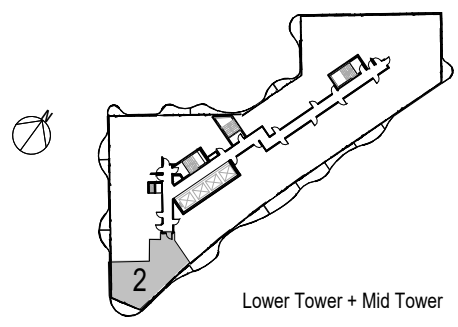
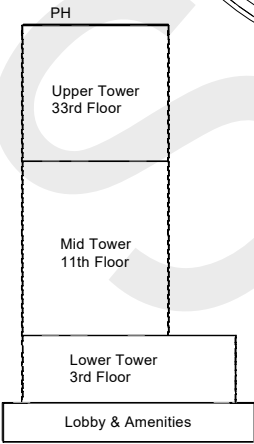
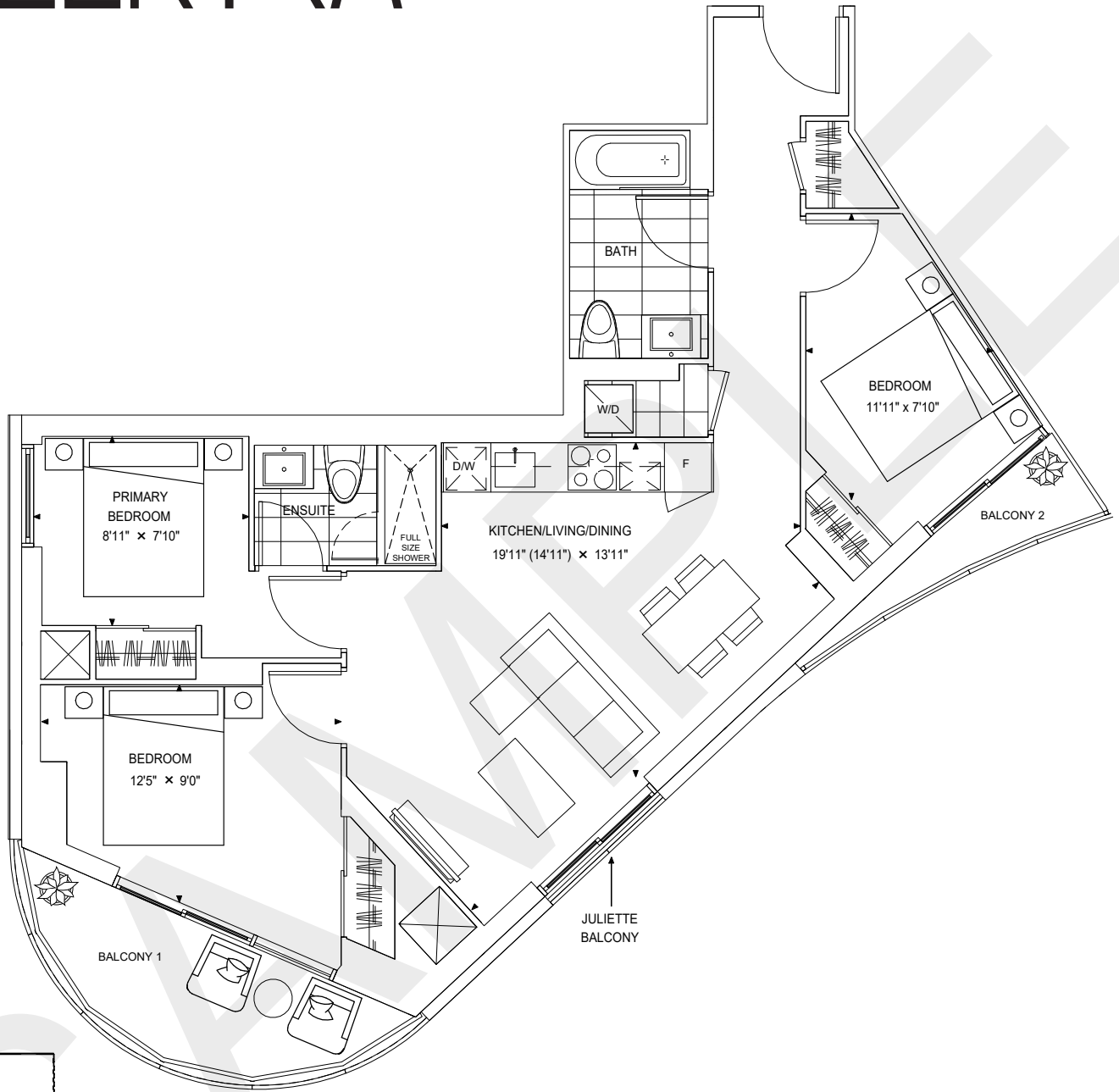

*Prices, sizes and specifications subject to change without notice, E.&O.E. The dimensions shown of this plan are approximate and subject to normal construction variances. Actual useable floor space within the unit may vary from any stated floor areas or dimensions on this plan. Furniture is displayed for illustration purposes only and does not necessarily reflect the electrical plan for the suite. Suites are sold unfurnished. For more information on the method used for calculating the floor area of any unit, reference should be made to Home Construction Regulatory Authority ("HCRA") Directive.

ELEKTRA

GRAND 871

3 BED, 2 BATH
 INTERIOR: 871 SQ.FT
 BALCONY 1 & 2: 90 SQ.FT
 TOTAL: 961 SQ.FT

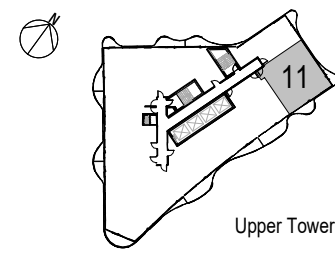
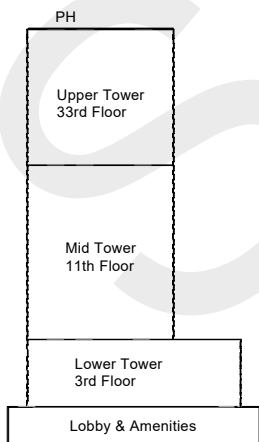
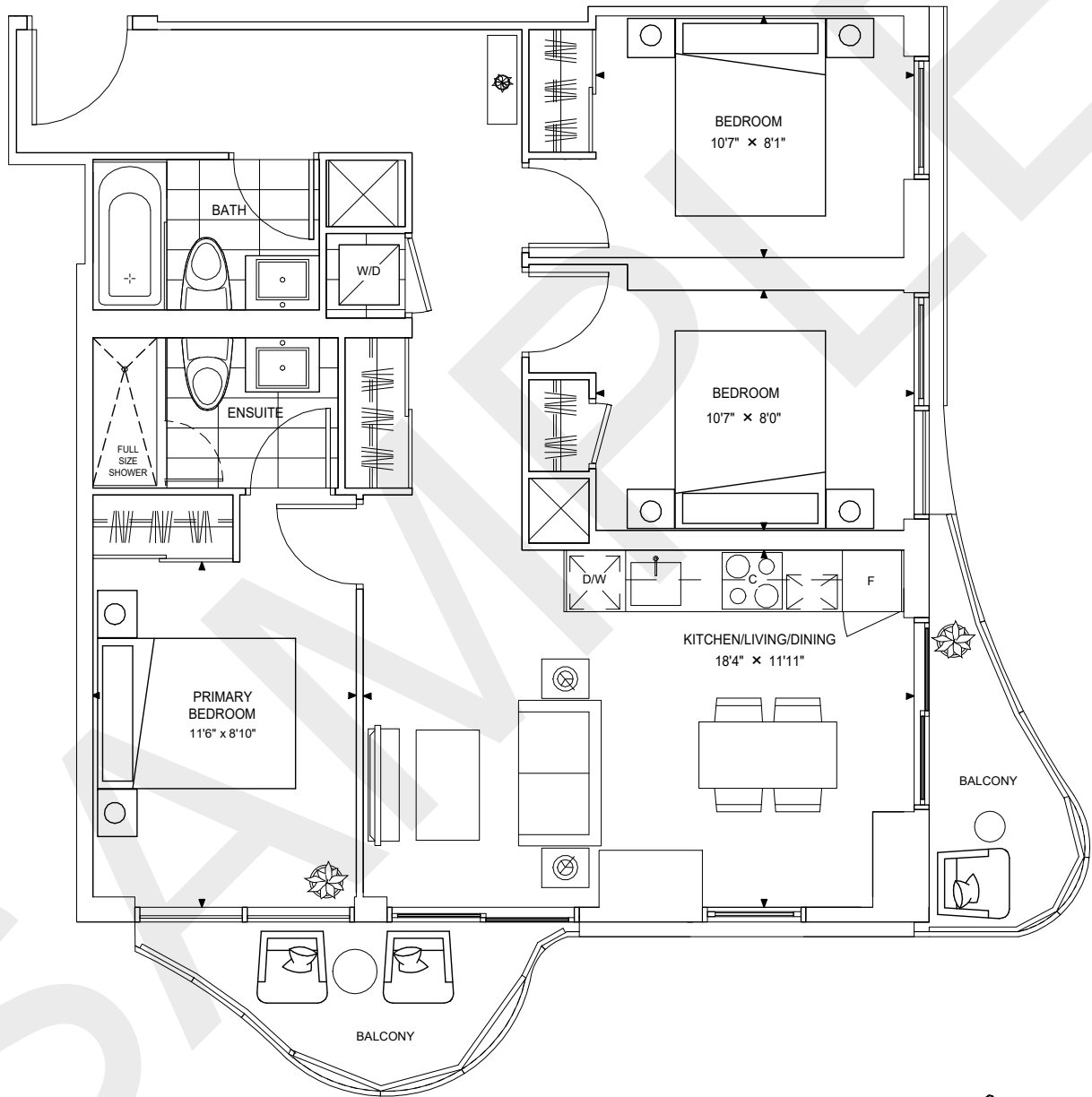

*Prices, sizes and specifications subject to change without notice, E.&O.E. The dimensions shown of this plan are approximate and subject to normal construction variances. Actual useable floor space within the unit may vary from any stated floor areas or dimensions on this plan. Furniture is displayed for illustration purposes only and does not necessarily reflect the electrical plan for the suite. Suites are sold unfurnished. For more information on the method used for calculating the floor area of any unit, reference should be made to Home Construction Regulatory Authority ("HCRA") Directive.